

Installation Method

STEP 1:

Place the stand with double sided tape and place speaker and secure it

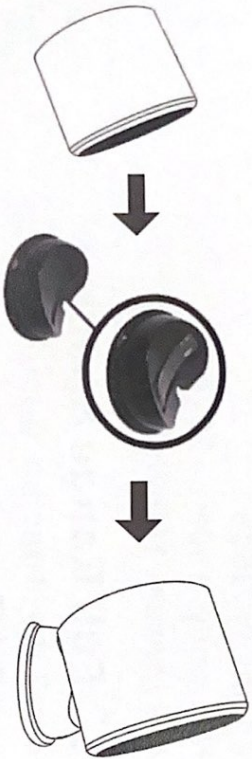

STEP 2:

The vibrating membrane goes backwards



STEP 3:
Now join wire to the existing player speaker wire

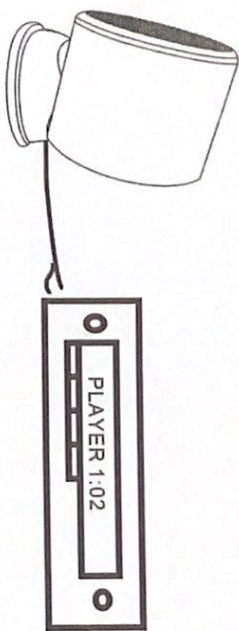

SIZE:

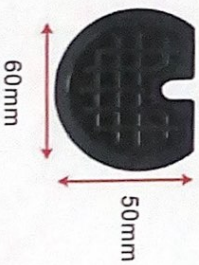
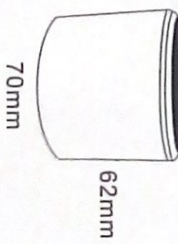
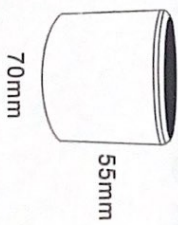
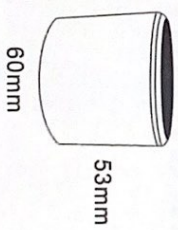

FULL RANGE SPEAKER

Instruction Manual

FEATURE:

2" Full Range Speaker

Cone Type: Titanium Dome
Voice Coil Diameter: 20mm
Magnet Type: Neodymium
Impedance: 2.8Ω
Sensitivity: 95db
Frequency: 150Hz - 20KHz
Peak Power : 180 Watts

2.5" Full Range Speaker

Cone Type: Titanium Dome
Voice Coil Diameter: 25mm
Magnet Type: Neodymium
Impedance: 2.8Ω
Sensitivity: 95db
Frequency: 150Hz - 20KHz
Peak Power : 220 Watts

2.5" Full Range Speaker with tweeter

Cone Type: Titanium Dome
Voice Coil Diameter: 25mm
Magnet Type: Neodymium
Impedance: 2.8Ω
Sensitivity: 95db
Frequency: 150Hz - 20KHz
Peak Power : 220 Watts